

TECHNICAL
SPECIFICATIONS

Product Code	PMASYM-HI99-PIH
Dimension (mm) W x L x H	16x16x4,88
Material	PMMA
Fastening	Pin, Glue
Beam Angle	Medium, Type II
Type	1
Optical Efficiency	%93
Rohs Complaint	Yes

MATERIALS

PMMA clear, Non-yellowing for 10 years.

Yellowness Index (YI) according to the test standarts for Arizona/Florida outdoor exposure testing:

- YI 6 under hot/dry conditions
- YI 8 under hot/wet conditions

INSTRUCTIONS FOR USE &
MAINTENANCE

Working Temperature : -40° C ~ +100° C

Storage Temperature : -40° C ~ +100° C

Please handle or install lenses with wearing gloves.

Skin oils may damage lens or its optical characteristic.

Never use any commercial cleaning solvents on lenses , like alcohol.

If necessary, clean lenses wiht mild soap, water and soft cloth.

SAMSUNG LH351B

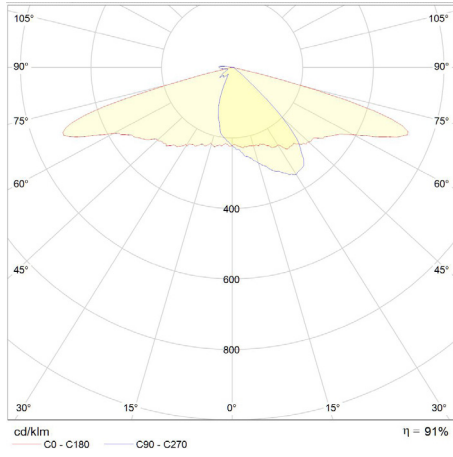

CREE XPG3

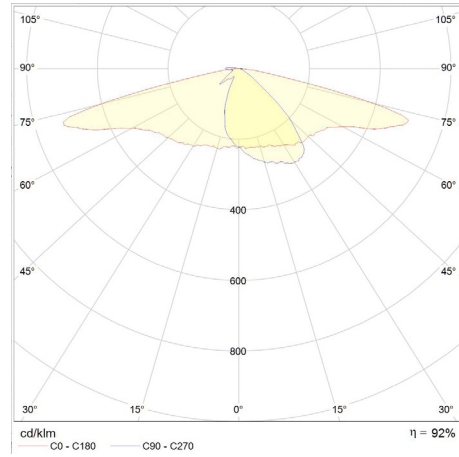

NICHIA NVSW219D

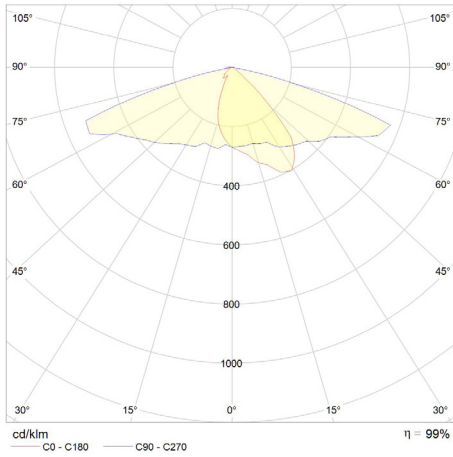

OSRAM OSLON SQUARE

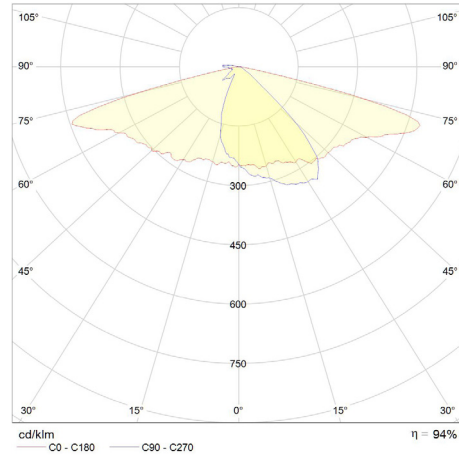

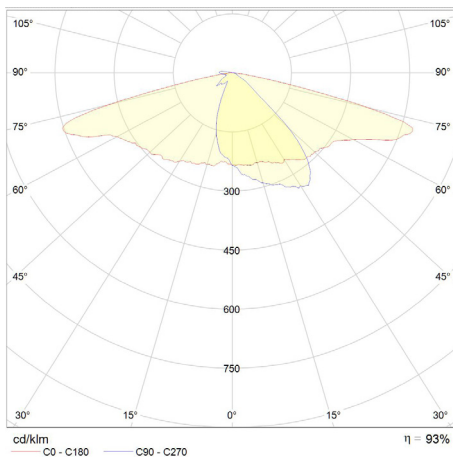

CREE XTE

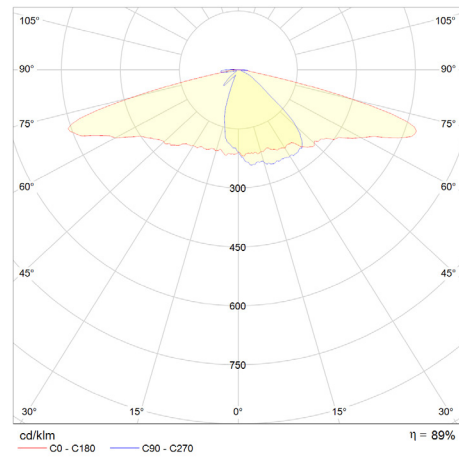

SEOUL Z5-M3

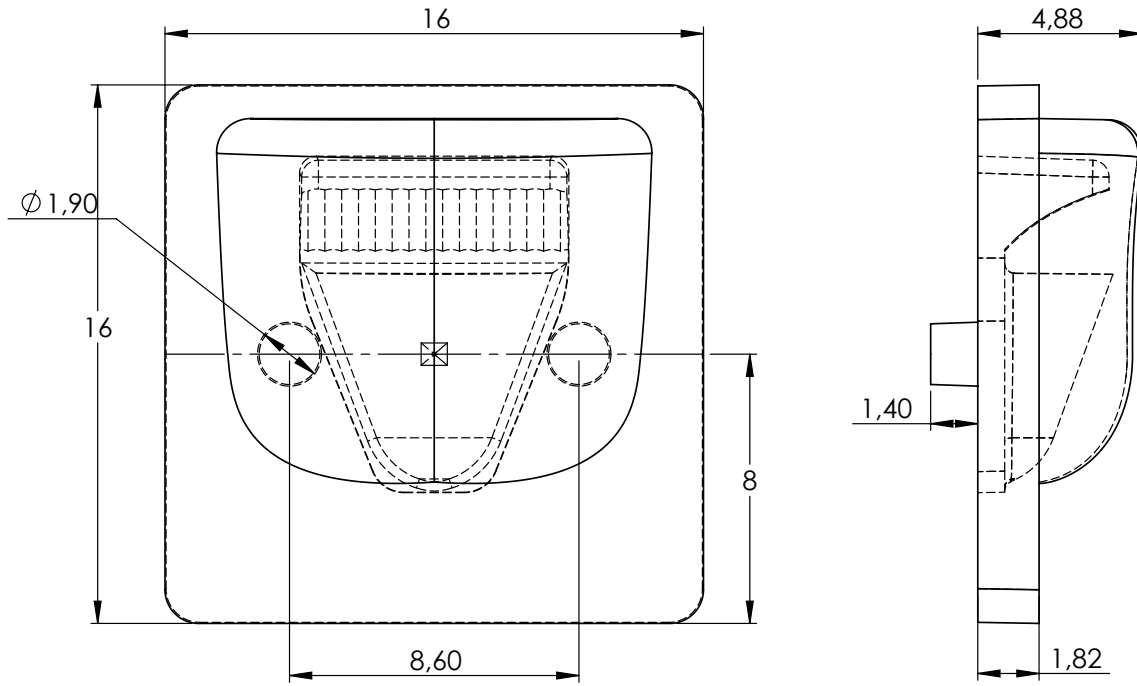

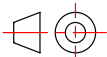

	UNIT mm	PART NO: PMASYM-HI99-PIH	 GENERAL TOLERANCES ± 0,2 MM	
	MATERIAL	PMMA	REV.	REVISION
	WEIGHT	0,74 g	1	
	DATE	22.06.2020	2	
			3	
		PAGE 1 / 1	FORM A4	SCALE 1:1

Box Size (mm) W x L x H	130x130x125
Box Weight	0,63 Kg
Box Quantity	750 pcs